



Application Procedure

Watch the Application Videos on www.offloading-device.com "How to apply".



1
Open valve cap.



2
Pull valve ring upwards and move it to the side to allow air to flow in.



3
Remove upper shell.



5
Shake and smooth out the liner to release the vacuum beads.



6
Place foot into the back of the fabric liner and close Velcros.



7
Position liner with foot in lower shell.



8
Position foot in the back of the lower shell.



9
Pull the fabric liner upwards.



10
Attach upper shell. Valve must not be broken or covered by upper shell.



11
Correct position of upper shell: front = inside lower shell. Top = outside lower shell.



12
OPED
Keeps you going.



13
Close straps in the right order, beginning with strap 1.

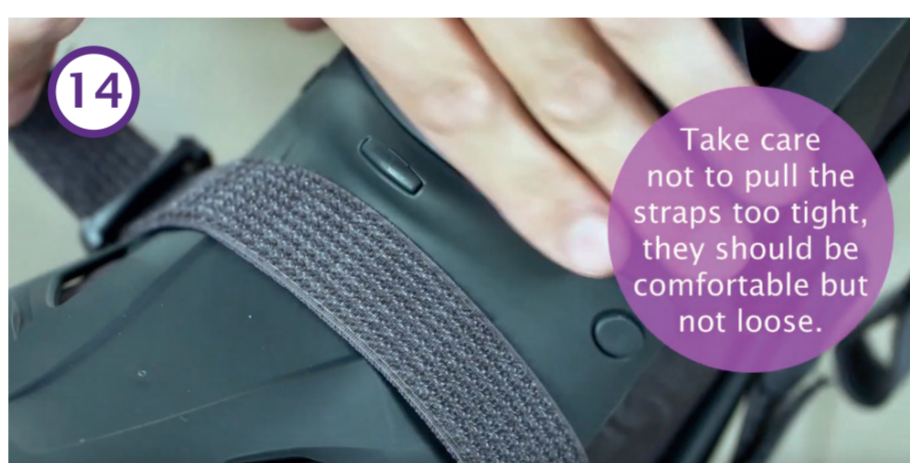

14
Take care not to pull the straps too tight, they should be comfortable but not loose.



15
OPED
Keeps you going.



16
Stand up and put weight on the foot once for anatomical fitting.

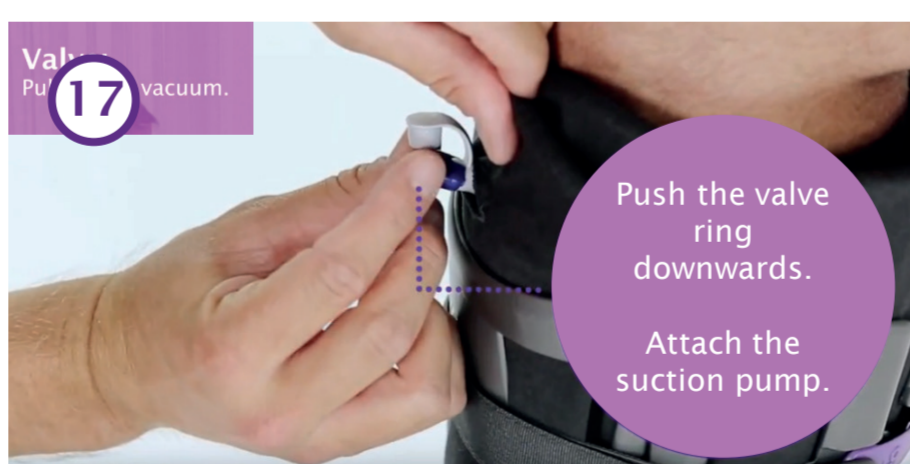

17
Valve Pushed down to vacuum.
Push the valve ring downwards.
Attach the suction pump.

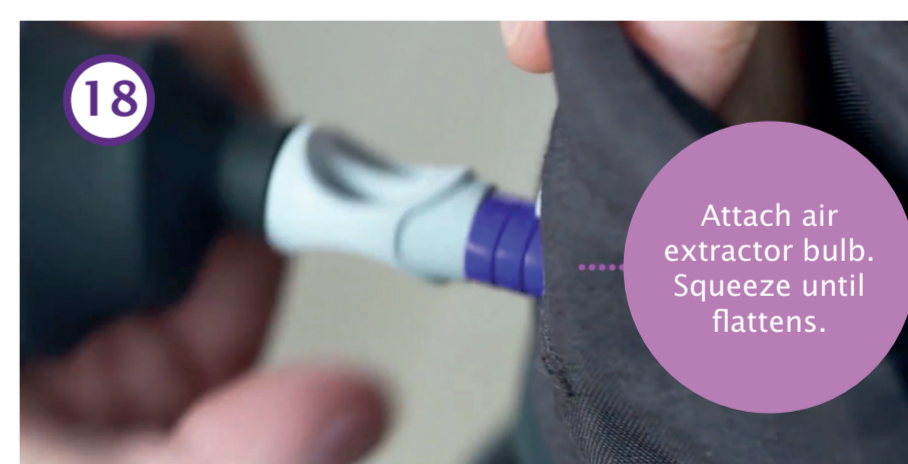

18
Attach air extractor bulb. Squeeze until flattens.



19
OPED
Keeps you going.

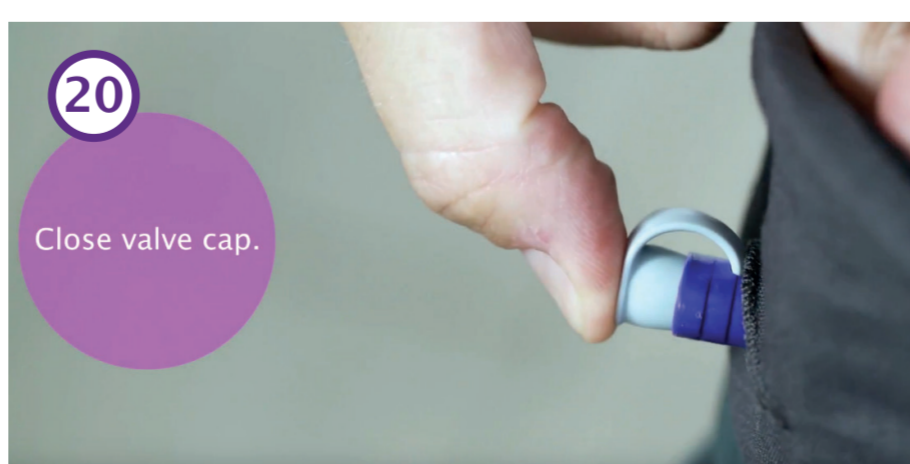

20
Close valve cap.



21
We recommend a couple of vacuum suction each day to keep the beads in a static position!